

Pressure Gauge

SG-FK5112 Fire Extinguishing System

Specification

General Description	Indicator for pressure of cylinder
4VcaMReZ_?`Z	EX28621
>ReVGzJA	Stainless Steel/PolycarbonateA

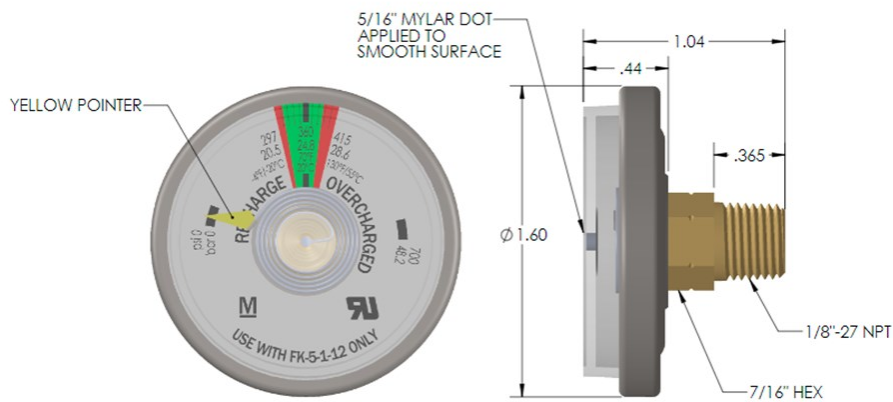

25 Bar Pressure Gauge

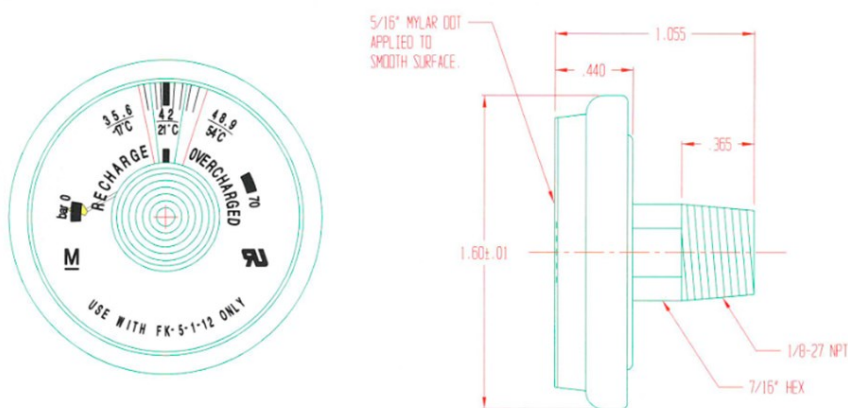

42 Bar Pressure Gauge

Pressure Gauge

SG-FK5112 Fire Extinguishing System

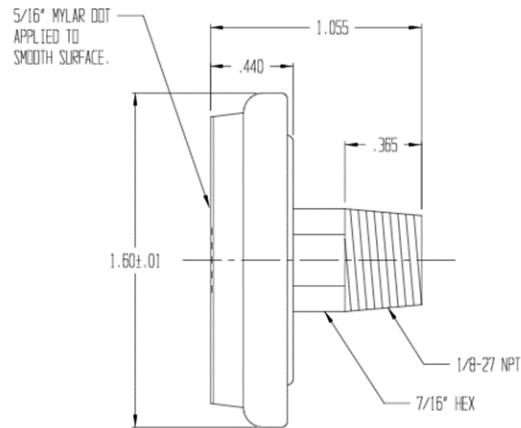

50 Bar Pressure Gauge

Part Number	SG170-PG-25B-FK	SG170-PG-42B-FK	SG170-PG-50B-FK
Type	Spring Tube Manometer	Spring Tube Manometer	Spring Tube Manometer
Pressure	25 Bar	42 Bar	50 Bar
Temperature Range	-10°C to 60°C	-10°C to 60°C	-10°C to 60°C
Connection to Valve	-1/8"NPT	- 1/8"NPT	1/8"NPT