

NOTES:
GRID OF LOCAL ORIGIN.
LEVELS NOT RELATIVE TO DRAIN
BASED ON A.M. AS SHOWN
UNLESS NOTED

KEY:-
F-C FLOOR TO CEILING
F-S FLOOR TO SILL
S-H SILL TO HEAD
F-H FLOOR TO HEAD
F-SPR FLOOR TO SPRING
F-TOP FLOOR TO TOP OF ARCH
+0.00 CHANGE IN HEIGHT
F.L. FINISHED FLOOR LEVEL
DIRECTION OF INCLINE
DP DOWN PIPE
VP VENT PIPE
G GULLY
IC INSPECTION CHAMBER

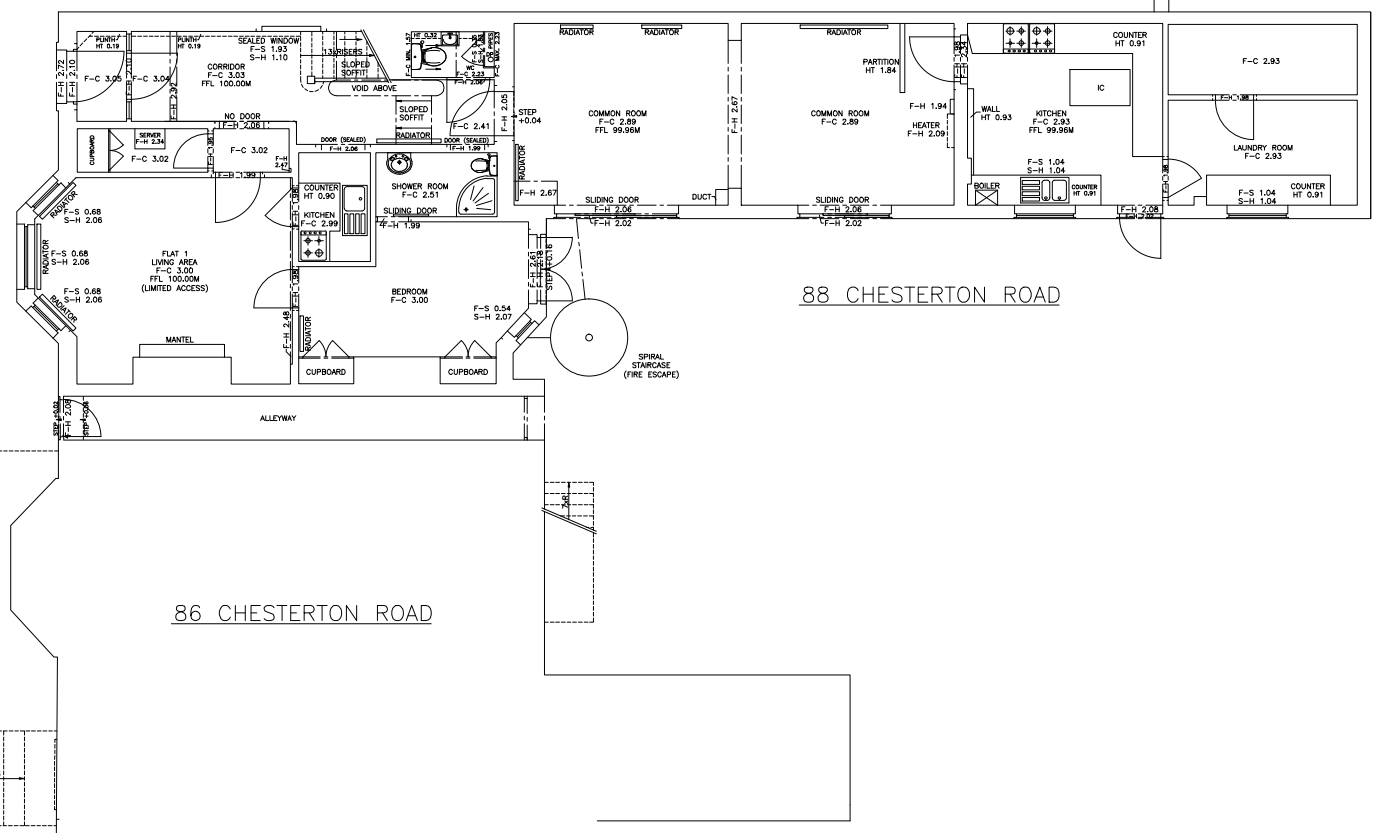

88 CHESTERTON ROAD

86 CHESTERTON ROAD

GROUND FLOOR PLAN

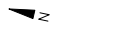
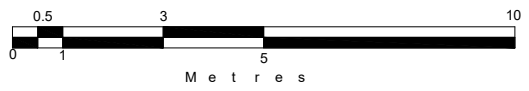

NORTH ARROW GRAPHICALLY ORIENTATED

CLIENT LUCY CAMERON COLLEGE
1400 WILKINSON ROAD
CAMBRIDGE CB2 0DQ

LOCATION 88 CHESTERTON ROAD
CAMBRIDGE CB4 1TD

TITLE FLOOR PLANS

DRAWING NUMBER	SCALE	SHEET
MS-0422A SHEET 1 OF 3	1:50	A1
AUTHOR JMT/ALC/DC	DATE	SEPT 2018

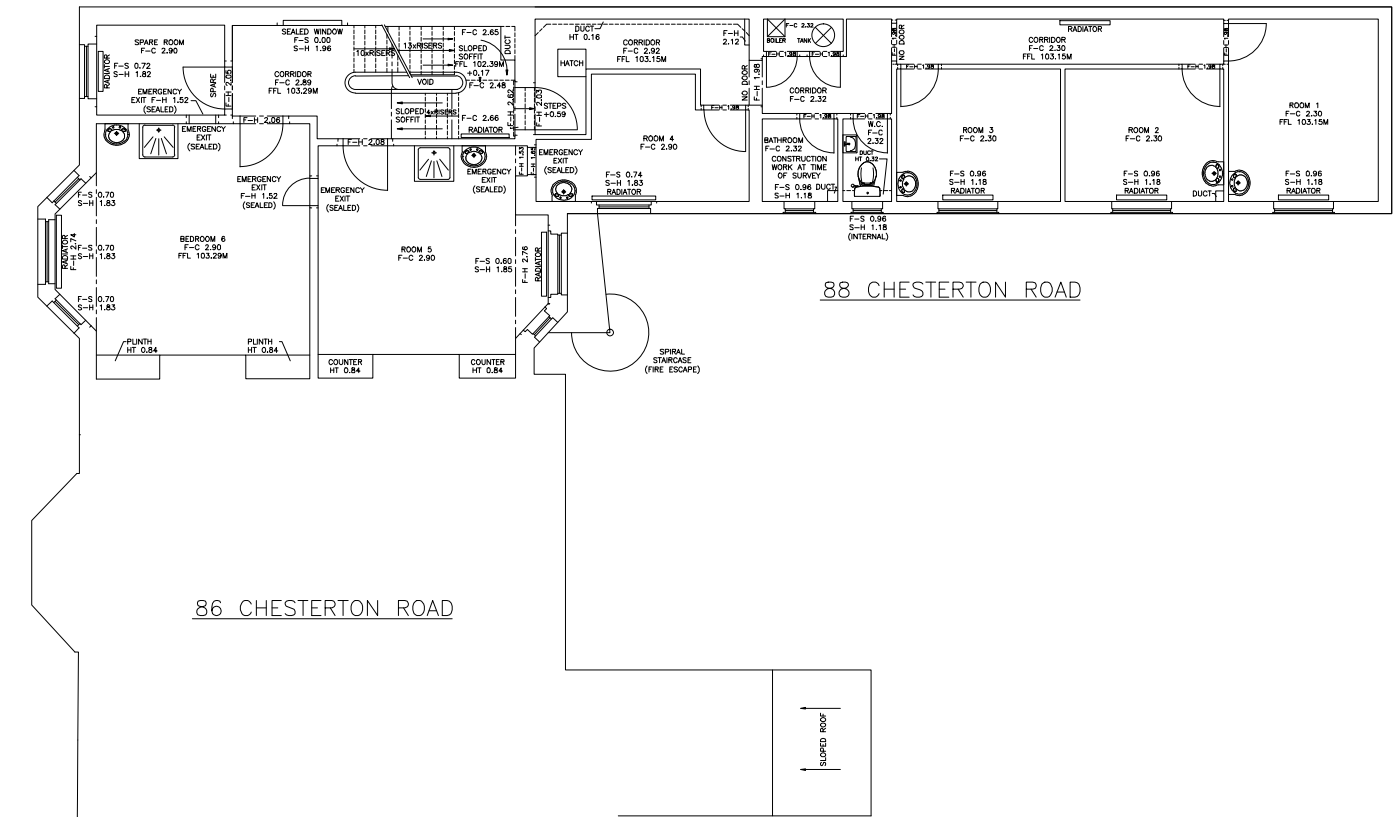

FIRST FLOOR PLAN

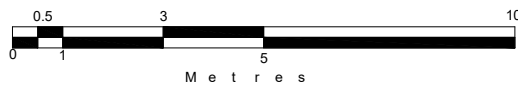

- NOTES:
GRID OF LOCAL ORIGIN.
LEVELS NOT RELATIVE TO DRAIN
BASED ON 101.45 SHOWN
UNLESS NOTED
- KEY:-
F-C FLOOR TO CEILING
F-S FLOOR TO SILL
S-H SILL TO HEAD
F-H FLOOR TO HEAD
F-SPR FLOOR TO SPRING
F-TOP FLOOR TO TOP OF ARCH
+0.00 CHANGE IN HEIGHT
FFL FINISHED FLOOR LEVEL
F-I FLOOR TO TOP OF INCLINE
DP DOWN PIPE
VP VENT PIPE
G GULLY
IC INSPECTION CHAMBER



NORTH ARROW GRAPHICALLY ORIENTATED

CLIENT LUCY CHANDLER COLLEGE
1400 WILSON ROAD
CAMBRIDGE CB3 0PL

LOCATION 88 CHESTERTON ROAD
CAMBRIDGE CB4 1TQ

TITLE FLOOR PLANS

DRAWING NUMBER	SCALE	SHEET
MS-0423 SHEET 2 OF 3	1:50	A1
AUTHOR JMT/ALC/DC	DATE	SEPT 2018

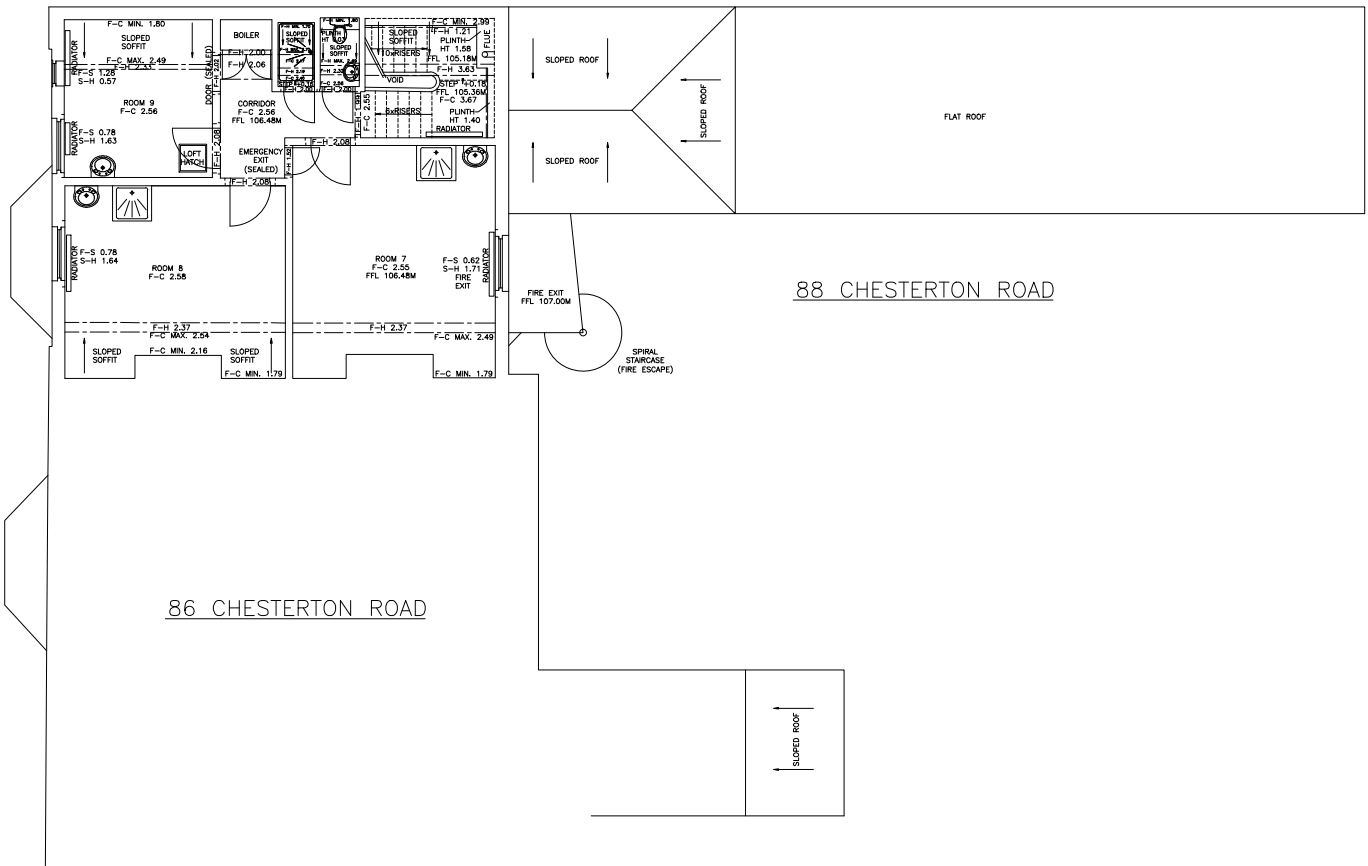

SECOND FLOOR PLAN

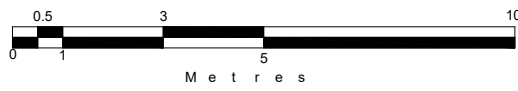

NOTES:
GRID OF LOCAL ORIGIN.
LEVELS NOT RELATIVE TO DRAIN
BASED ON LL. AS SHOWN
UNLESS NOTED

KEY:-
F-C FLOOR TO CEILING
F-S FLOOR TO SILL
S-H SILL TO HEAD
F-H FLOOR TO HEAD
F-SR FLOOR TO SPRING
F-TOP FLOOR TO TOP OF ARCH
+0.00 CHANGE IN HEIGHT
FFL FINISHED FLOOR LEVEL
DIRECTION OF INCLINE
DP DOWN PIPE
VP VENT PIPE
G GULLY
IC INSPECTION CHAMBER



NORTH ARROW GRAPHICALLY ORIENTATED

CLIENT LUCY DAMENSHI COLLEGE
1400 WILMINGTON ROAD
CAMBRIDGE CB2 1DQ

LOCATION 88 CHESTERTON ROAD
CAMBRIDGE CB4 1TQ

TITLE FLOOR PLANS

DRAWING NUMBER	SCALE	SHEET
MS-0423 SHEET 3 OF 3	1:50	A1
AUTHOR	DATE	
JW/AL/DC	SEPT 2018	